

PROJECT NAME:
 PLAN OF PROPOSED (G+11) TWELVE STORIED RESIDENTIAL CUM COMMERCIAL BUILDING (BLOCK-01) OF MR. DEBABRATA CHATTERJEE S/O LAKSHMIKANTA CHATTERJEE, MR. SUBRATA CHATTERJEE S/O LAKSHMIKANTA CHATTERJEE, MR. JOYDEB CHATTERJEE S/O LAKSHMIKANTA CHATTERJEE (SHREE CHAITANYA DEVELOPERS) R.S PLOT NO-931, L.R PLOT NO-725, L.R KHATIAN NO-6395,6396,6397. J.L. NO- 58, MOUZA-BAMUNARA, P. S -KANKSA, DIST-PASCHIM BARDHAMAN, WEST BENGAL.

SCHEDULE OF DOOR & WINDOW:-

MARK	SIZE	DESCRIPTION
D1	1000X2100	FULLY PNL
D2	900X2100	FULLY PNL
D3	750X2100	FULLY PNL
W	1800X1200	SLIDING WINDOW
W1	1500X1200	SLIDING WINDOW
W2	1200X1200	SLIDING WINDOW
W4	900X1200	SLIDING WINDOW
V		VENTILATION FOR STAIR CASE
V4	600X450	UPVC MOVABLE VENTILATOR

- *** NOTES :-**
1. ALL DIMENSIONS ARE IN M.M. AND ALL LEVEL ARE IN M.
 2. WRITTEN DIMENSIONS MUST BE FOLLOWED
 3. ALL EXTERNAL WALLS 250TH. & INTERNAL WALLS 125THK. UNLESS OTHERWISE MENTIONED.
 4. ALL MASONRY WORKS ARE BOUNDED BY CEMENT MORTAR (1:6) & (1:4).
 5. EXTERNAL PLASTER IS 25THK. & INTERNAL PLASTER IS 12MM.THK.
 6. ALL CONC. GRADE IS M25 & AND GRADE OF STEEL FE-500
 7. 250THK. BRICK WORK IN 1:6 MORTAR
 8. 125THK. & 75THK. BRICK WORK IN 1:4 MORTAR
 9. 150 WIDE SURFACE DRAIN SHOULD BE PROVIDED ALL ROUND THE BUILDING.
 10. 25% OF THE BUILDING TO BE CONSTRUCTED USING FLY-ASH BRICKS

AREA CALCULATION :-

LAND AREA	PLINTH AREA
	GROUND FLOOR 546.95 SQ.M.
	FIRST FLOOR 519.91 SQ.M.
	SECOND FLOOR 519.91 SQ.M.
	THIRD FLOOR 519.91 SQ.M.
	FORTH FLOOR 519.91 SQ.M.
	FIFTH FLOOR 519.91 SQ.M.
	SIXTH FLOOR 519.91 SQ.M.
	SEVENTH FLOOR 519.91 SQ.M.
	EIGHT FLOOR 519.91 SQ.M.
	NINTH FLOOR 519.91 SQ.M.
	TENTH FLOOR 519.91 SQ.M.
	ELEVENTH FLOOR 519.91 SQ.M.
	TOTAL 6265.96 SQ.M.

GROUND COVERAGE = 14.81 %
 F.A.R = 1.29
 NO. OF FLATS = 66
 NO. OF CAR PARKING = 38

SIGNATURE OF DEVELOPER/OWNER :-

Debabrata Chatterjee
Subrata Chatterjee
Joydeb Chatterjee

TITLE:
 *GROUND FLOOR PLAN (BLOCK-01)
 *TYPICAL FLOOR PLAN (BLOCK-01)
 *ROOF FLOOR PLAN (BLOCK-01)

DRAWN BY: P.DEY

CHECKED BY:- M KHATUN

SCALE: 1:100.

REV.-00 DATE: 09.08.2022

SHEET NO: GIDS/P.H./P&R-02/04

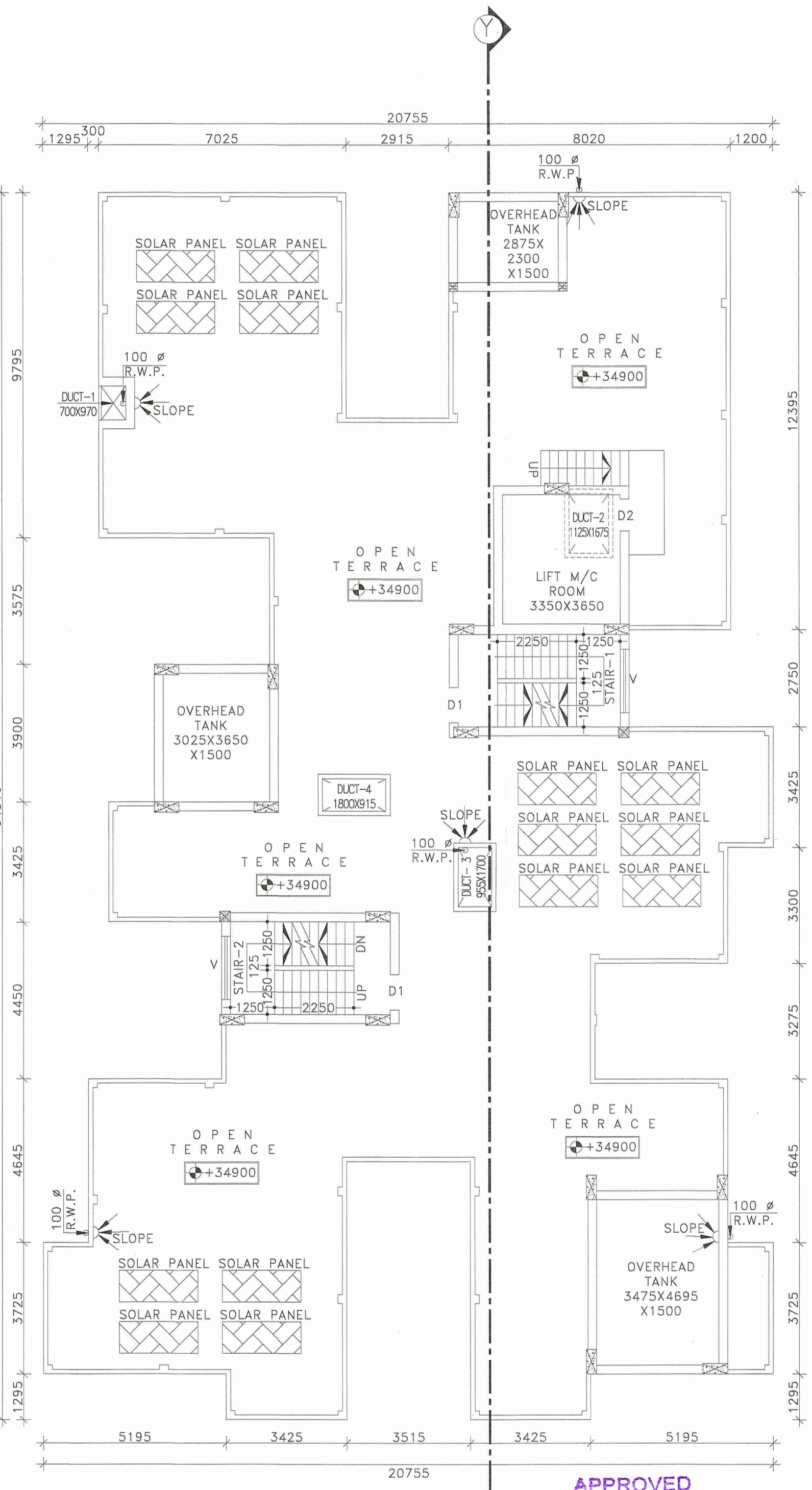
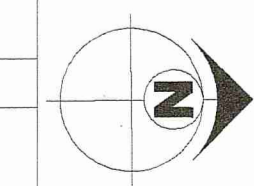

E ROOF FLOOR PLAN(BLOCK-01)
 SCALE: 1:100

Ref: Memo no. 4865/P302P dt. 3.11.22
 Additional Executive Officer
 Paschim Bardhaman Zilla Parishad.

APPROVED
 Pradip
 Gopalpur Gram Panchayat
 F.S.-Kanksa, Dist.-Paschim Bardhaman

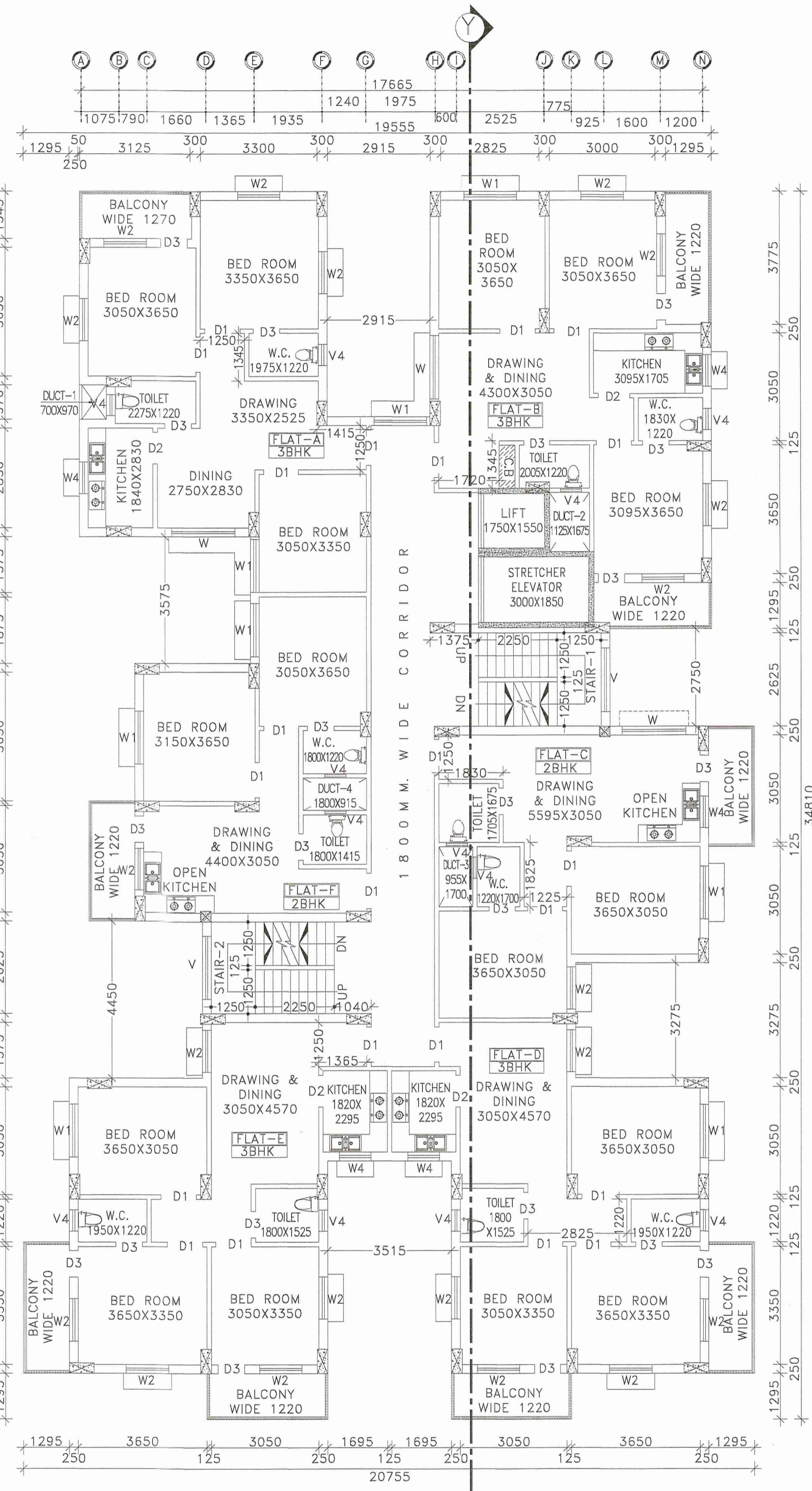

D TYPICAL FLOOR PLAN(BLOCK-01)
 SCALE: 1:100

SIGNATURE OF ARCHITECT :-
Vaishnavi Prasad (D) Athalye
 CONSULTING ARCHITECT
 CA/2018/101108

SIGNATURE OF STRUCTURAL ENGINEER :-
Hiron Bhowmik
 Structural Engineer
 Lic. No. L.B.P.M/163/AMC/DMC/PD/105
 DCE, B-TECH, G.I.D.S, Durgapur-16
 Contact No. - 780984157

SIGNATURE OF GEO TECHNICAL ENGINEER :-
M. D. J. Ghosh
 Civil / Geotechnical Engineer
 Lic. No. - LBPM/62/AMC
 G.I.D.S., Durgapur - 16

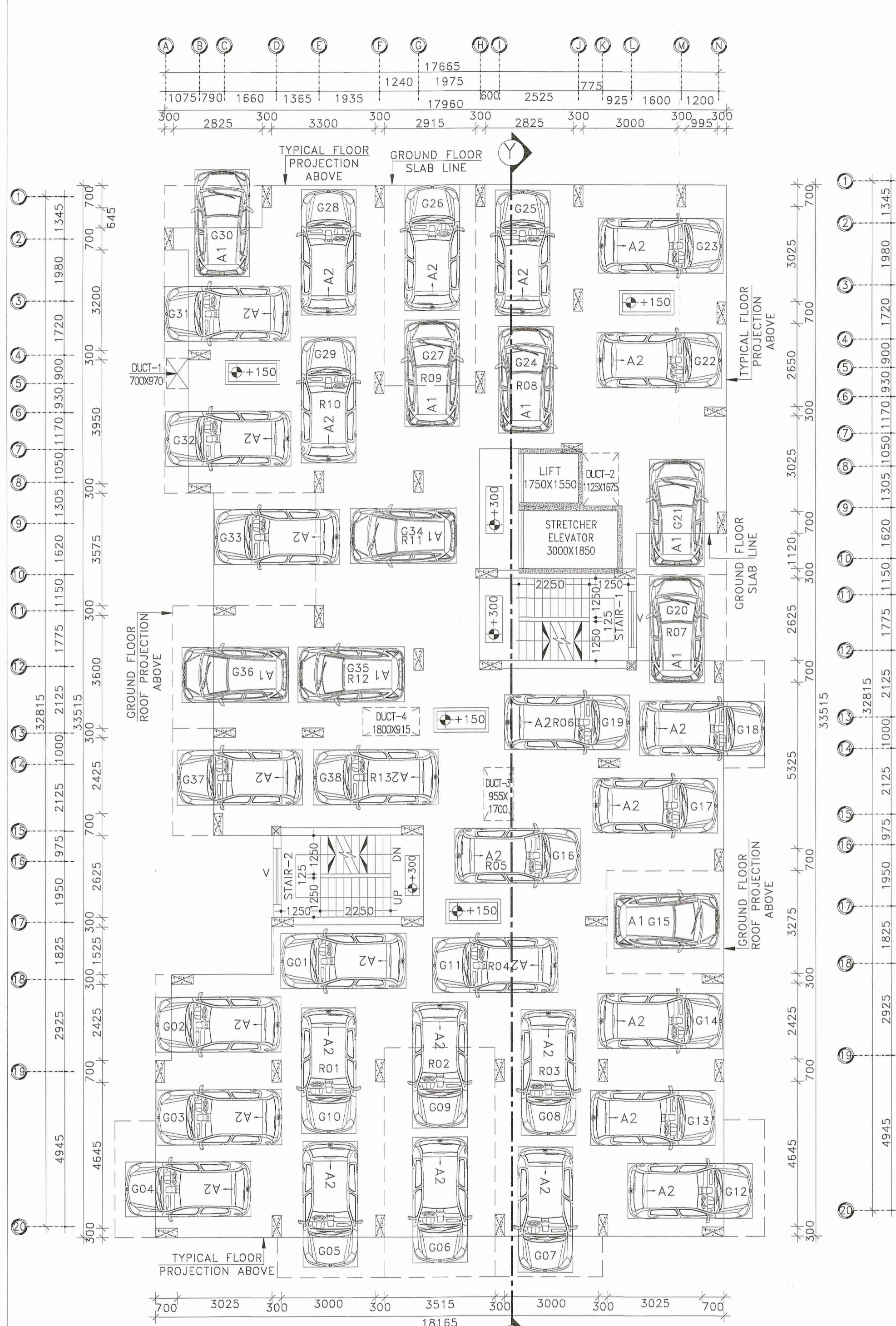

C GROUND FLOOR PLAN(BLOCK-01)
 SCALE: 1:100

SIGNATURE OF ARCHITECT :-
Vaishnavi Prasad (D) Athalye
 CONSULTING ARCHITECT
 CA/2018/101108